

My Maps Tutorial

2017 Free-Learning Conference: Appalachian State University
Sarah McCorkle, Wake Forest University

MyMaps.Google.com

Sign in to *MyMaps.Google.com* using your Google credentials. If your school uses Google's Gmail as your email system, sign in using your school email address and password.

Create a new map

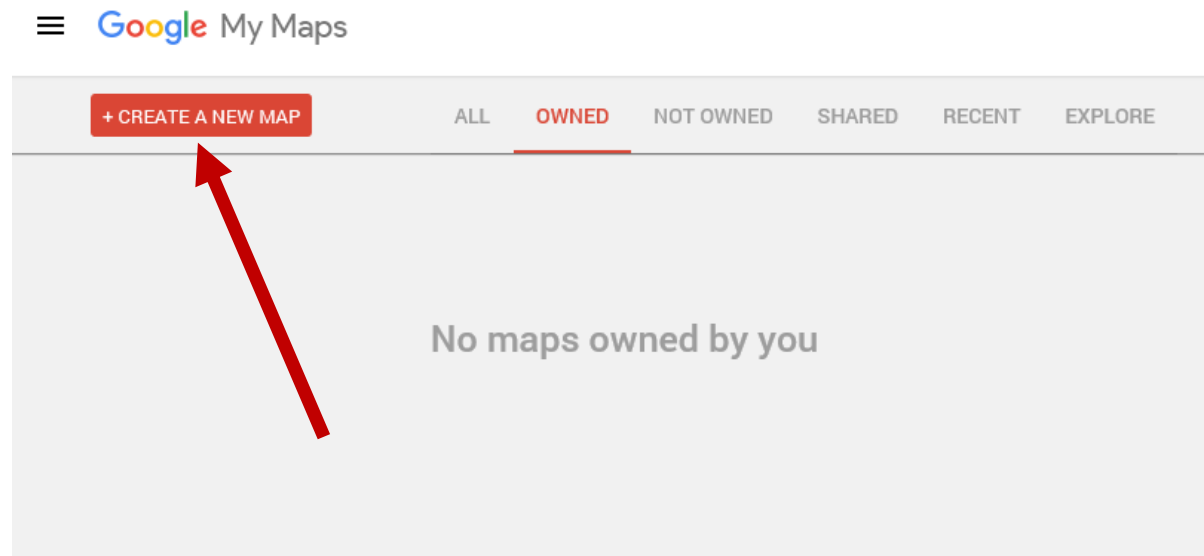

Click to give your map a title

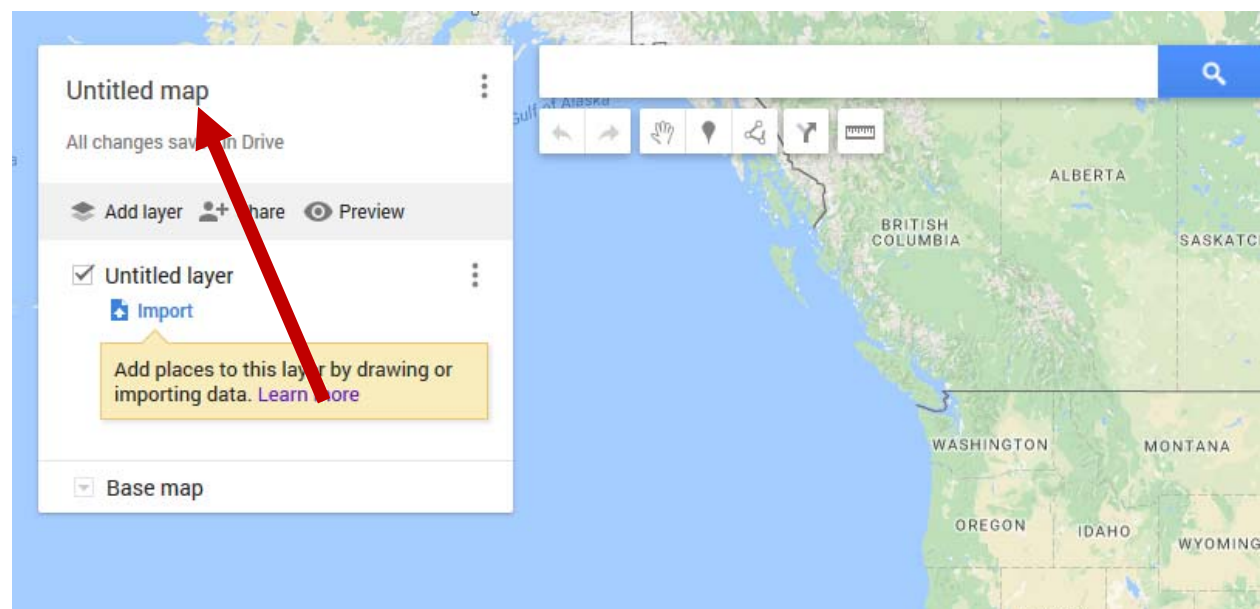

Add Layers (Optional)

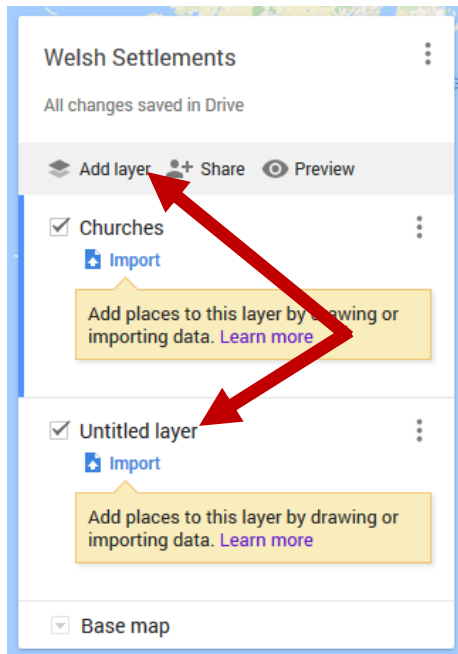

This map will have 2 layers: *Churches* and *Communities*. In this example, the layers provide some organization to the map and allow students to focus on one topic or the other.

1) Click “**Add layer**” to create another layer.

2) Click on “**Untitled layer**” to give it a name.

Add Marker: Search for a place of interest

Optional: If you have more than one layer on your map, begin by **clicking the layer** to select it (as indicated by the blue highlight along the left edge of the layer in this example). In this example we are adding a *church*.

Use the search bar at the top to locate a place of interest. Then click “**Add to map**”.

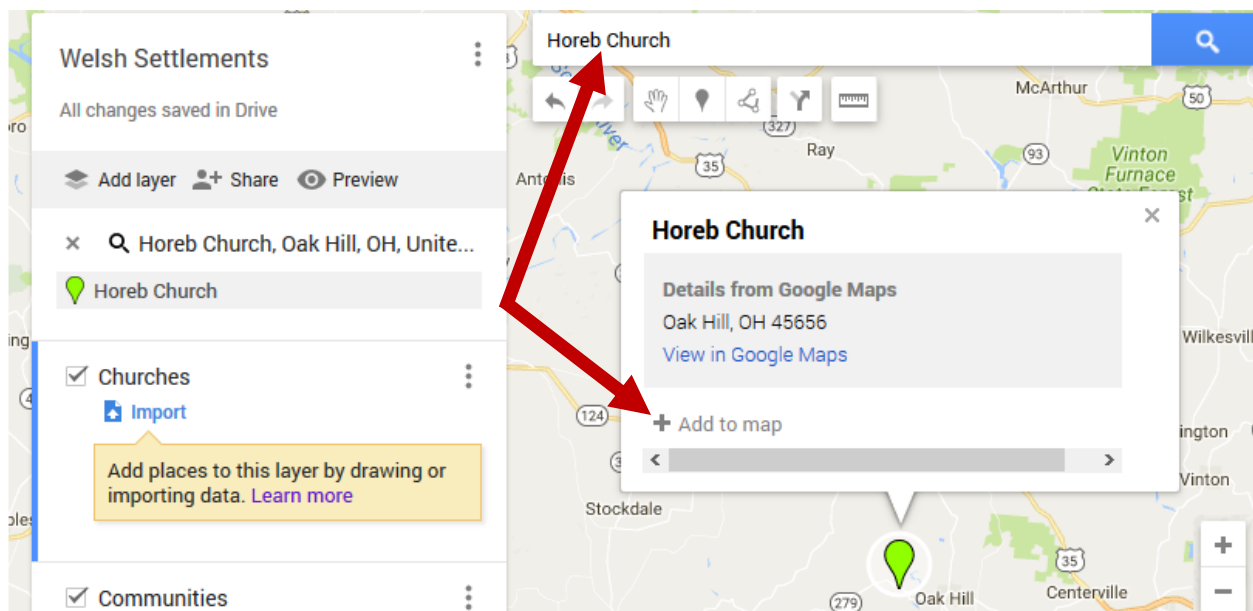

Add Marker: Explore the map for a place of interest

*Navigation tip: You can use the **zoom (+/-) icons** in the lower right corner of the map to zoom in or out of the map. Click the map and drag your mouse to move around the map.*

Optional: If you have more than one layer on your map, begin by **clicking the layer** to select it (as indicated by the blue highlight along the left edge of the layer in this example). In this example we are adding a *Community*.

Click the **marker icon** at the top – your mouse will change to a crosshair (+). Then **click a place** on the map where you would like to add this marker and **give it a name**. Click “**Save**” below.

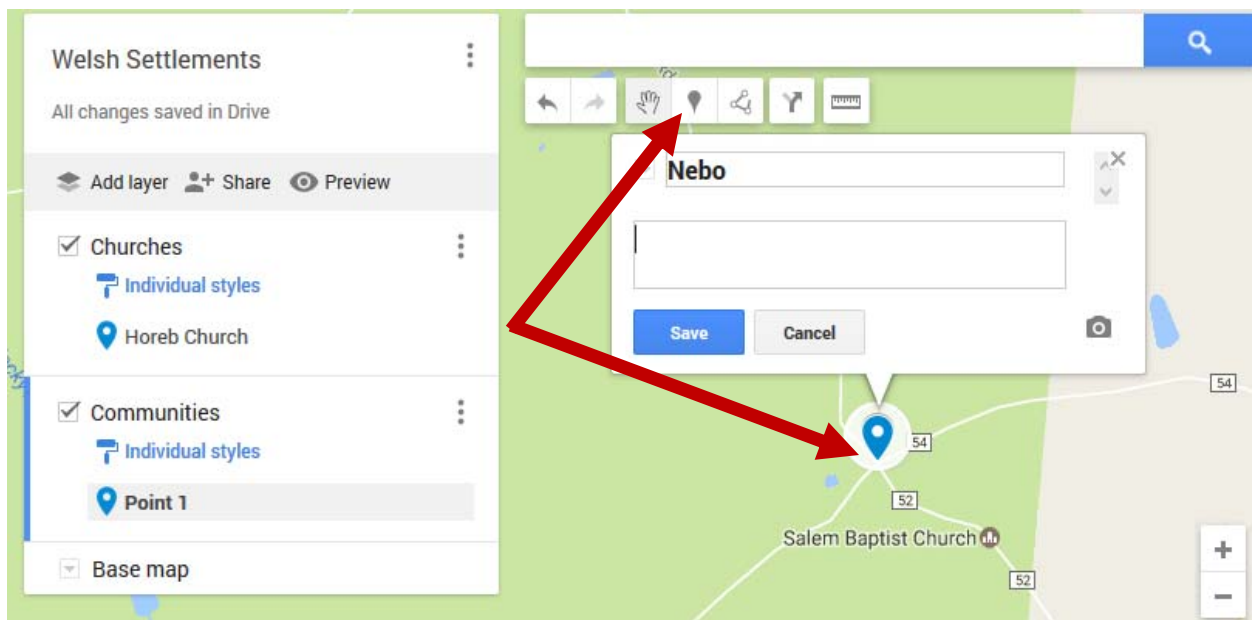

Edit markers to include additional information

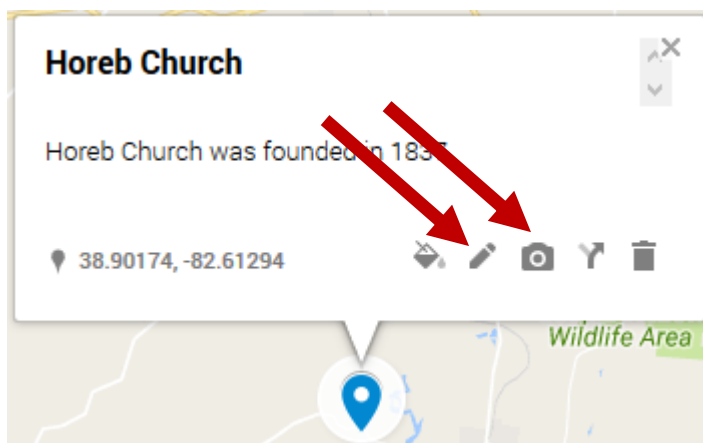

You can include additional information on each marker such as text, links, photos, and videos.

To add text or a link to a website, click the **pencil icon**. Any website preceded by `http://` will be turned into a clickable link once you have saved your changes.

To add a photo or a video, click on the **camera icon**.

Remember to include a citation to any multimedia you find on the Internet.

Share and Collaborate

Click the “Share” link.

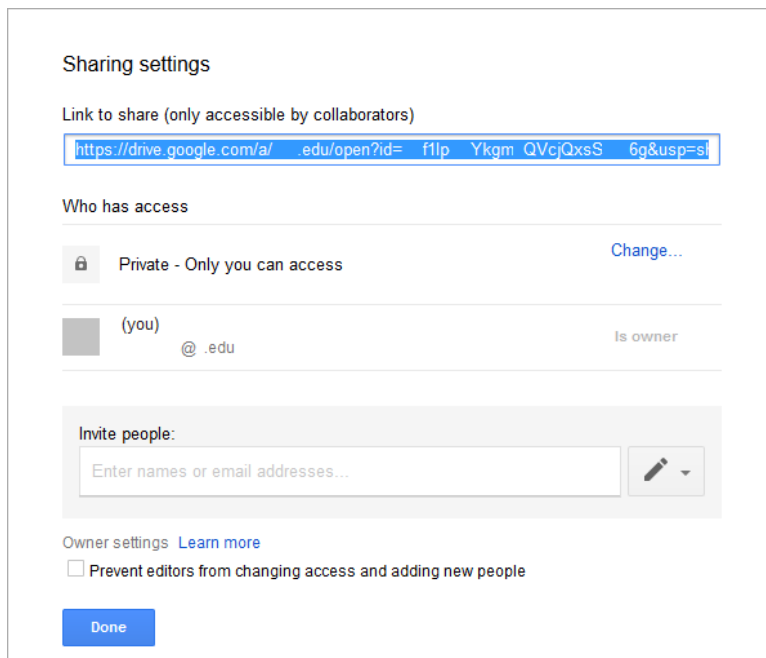
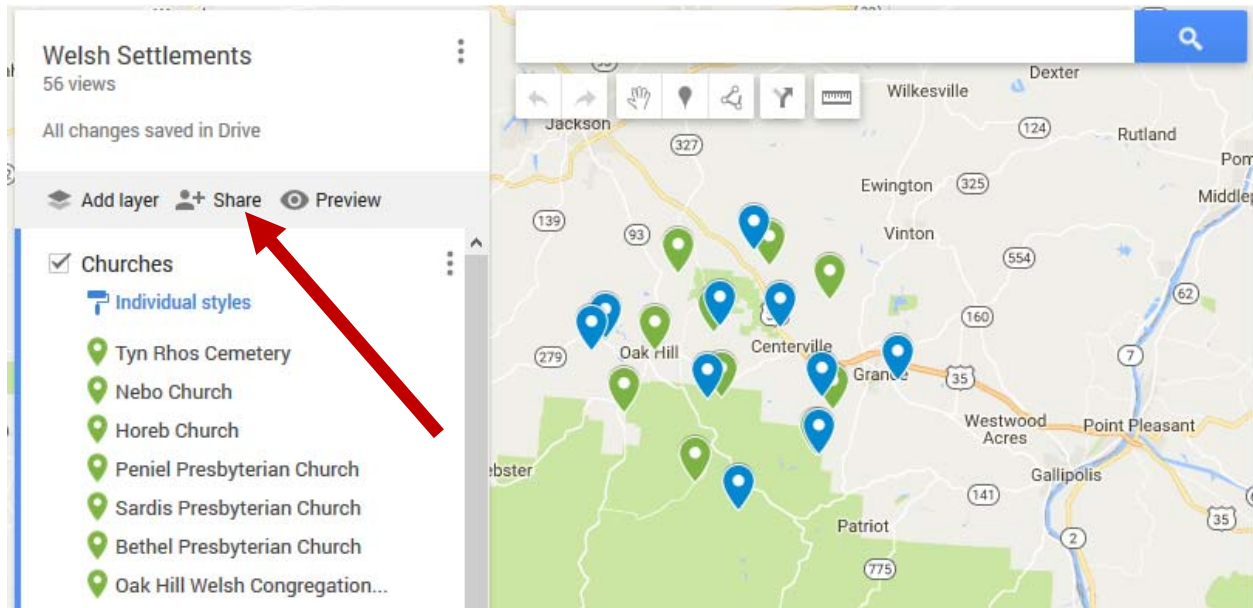

MyMaps has the same sharing features as found in Google Drive.

This means you can invite others to collaborate with you and build a map, share the map with a specific list of people, or share your map publically.

If your school uses Google Accounts contact your system administrators for more information on the sharing types available to you.